

# ATLANTIC

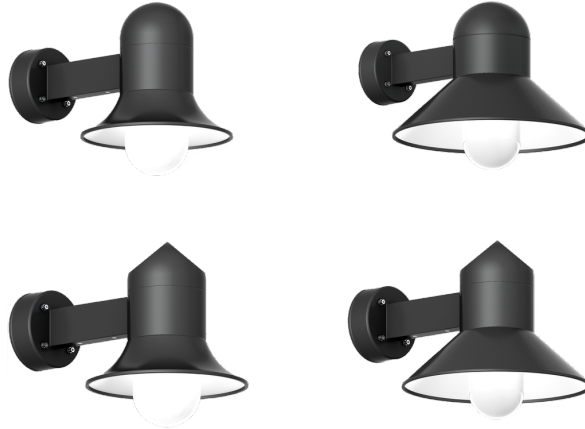

Classic urban neighbourhood wall-mounted luminaire family. Timeless lines coupled with unparalleled build quality, flexibility and performance.



## Luminaire Structure

- Pre-treated before powder coating ensuring high corrosion resistance
- Die-cast aluminium housing
- Two cable entries for through wiring
- Stainless steel fasteners in grade 304 with zinc flake coating (ZFC)
- Durable silicone rubber gasket
- Opal toughened glass diffuser
- Integral control gear

## Feature



## Optic

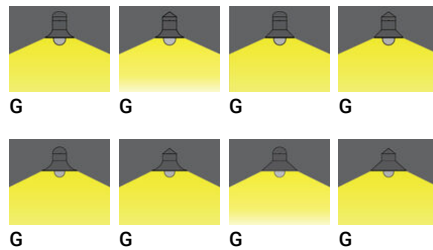

## Product colour

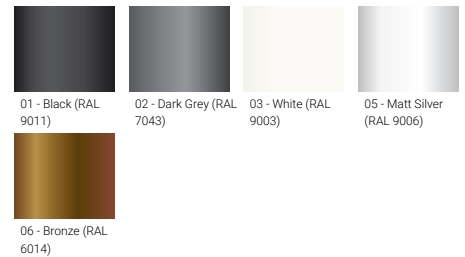

## Special finishes upon request

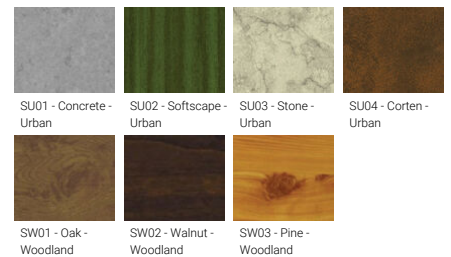

# ATLANTIC

## Technical information

	Model number	Light source	Power	Lumen	Optic	CCT / CRI	Dimming type	Weight
<b>Medium - Straight shade - Cone top</b>								
ATLANTIC 8	AA-30156-2-2	1 COB	41 W	3015 - 3174 lm	G [144°]	3000K CRI80, 4000K CRI80	On/Off, 1-10V, DALI	8.9 kg
<b>Medium - Straight shade - Dome top</b>								
ATLANTIC 8	AA-30156-2-1	1 COB	41 W	3015 - 3174 lm	G [144°]	3000K CRI80, 4000K CRI80	On/Off, 1-10V, DALI	8.9 kg
<b>Medium - Swept shade - Cone top</b>								
ATLANTIC 8	AA-30156-1-2	1 COB	41 W	2976 - 3134 lm	G [144°]	3000K CRI80, 4000K CRI80	On/Off, 1-10V, DALI	8.9 kg
<b>Medium - Swept shade - Dome top</b>								
ATLANTIC 8	AA-30156-1-1	1 COB	41 W	2976 - 3134 lm	G [144°]	3000K CRI80, 4000K CRI80	On/Off, 1-10V, DALI	8.9 kg
<b>Small - Straight shade - Cone top</b>								
ATLANTIC 7	AA-30146-2-2	1 COB	29 W	1082 - 1105 lm	G [144°]	3000K CRI80, 4000K CRI80	On/Off, 1-10V, DALI	6.3 kg
<b>Small - Straight shade - Dome top</b>								
ATLANTIC 7	AA-30146-2-1	1 COB	29 W	1082 - 1105 lm	G [144°]	3000K CRI80, 4000K CRI80	On/Off, 1-10V, DALI	6.3 kg
<b>Small - Swept shade - Cone top</b>								
ATLANTIC 7	AA-30146-1-2	1 COB	29 W	1082 - 1105 lm	G [144°]	3000K CRI80, 4000K CRI80	On/Off, 1-10V, DALI	6.3 kg
<b>Small - Swept shade - Dome top</b>								
ATLANTIC 7	AA-30146-1-1	1 COB	29 W	1082 - 1105 lm	G [144°]	3000K CRI80, 4000K CRI80	On/Off, 1-10V, DALI	6.3 kg

## Accessories



DALI Control System  
Control-DALI

AA-30146-1-1	•
AA-30146-1-2	•
AA-30146-2-1	•
AA-30146-2-2	•
AA-30156-1-1	•
AA-30156-1-2	•
AA-30156-2-1	•
AA-30156-2-2	•

**ATLANTIC**

AA-30146-1-1

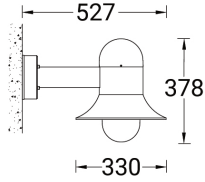
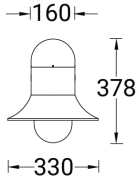

AA-30146-1-2

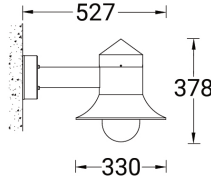

AA-30146-2-1

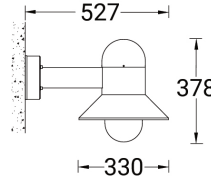

AA-30146-2-2

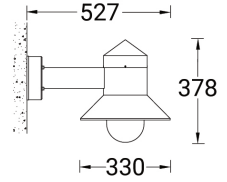

AA-30156-1-1

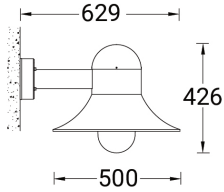
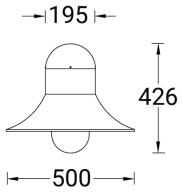

AA-30156-1-2

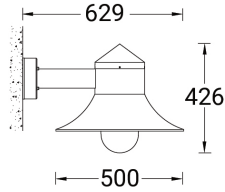

AA-30156-2-1

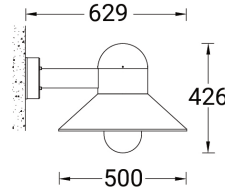

AA-30156-2-2

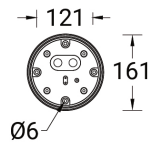
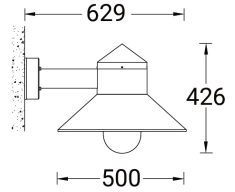

**ATLANTIC**



ATLANTIC  
**Shepherd's crook surface wall luminaires**

Classic urban neighbourhood wall-mounted luminaire family. Timeless lines coupled with unparalleled build quality, flexibility and performance.

<https://www.ligman.com/atlantic-shepherds-crook-surface-wall-luminaires-atl-su3/>



ATLANTIC  
**Pendant luminaires**

Classic urban neighborhood pendant luminaire family. Timeless lines coupled with the unparalleled build quality, flexibility and performance.

<https://www.ligman.com/atlantic-pendant-luminaires-at-pe3/>



ATLANTIC  
**Bollards**

Classic urban neighborhood bollard luminaire family. Timeless lines coupled with unparalleled build quality, flexibility and performance.

<https://www.ligman.com/atlantic-bollards-at-bo3/>



ATLANTIC  
**Shepherd's crook post top luminaires**

Classic urban neighbourhood post top luminaire family. Timeless lines coupled with unparalleled build quality, flexibility and performance.

<https://www.ligman.com/atlantic-shepherds-crook-post-top-luminaires-at-po3/>



ATLANTIC  
**Post top luminaires**

Classic urban neighbourhood post top luminaire family. Timeless lines coupled with unparalleled build quality, flexibility and performance.

<https://www.ligman.com/atlantic-post-top-luminaires-atl-po3/>



ATLANTIC  
**Shepherd's crook large post top**

Classic urban neighbourhood post top luminaire family. Timeless lines coupled with unparalleled build quality, flexibility and performance.

<https://www.ligman.com/atlantic-shepherds-crook-large-post-top-atla-po3/>