

ANNET 1 (AE-50177)



Product description

Without remote box IP-rated - With remote driver -
Constant current (CC) 700 mA



Luminaire Structure

- | | | |
|--|---|---|
| <ul style="list-style-type: none"> - Stainless steel body in grade 316 - Single cable entry - One cable gland supplied with 2 m of 2x1.0 sqmm outdoor cable - Stainless steel fasteners in grade 316 | <ul style="list-style-type: none"> - Durable silicone rubber gasket - Clear toughened glass - Remote driver (included) - Remote box IP-rated is not included and is to be ordered separately for constant current (CC) products | <ul style="list-style-type: none"> - Luminaire must be submerged when operational - Maximum depth 2 m - Outdoor cable needs to be ordered with a specific length |
|--|---|---|

Optic

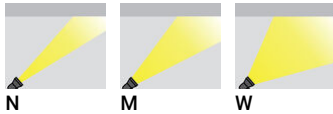

Product colour



ANNET 1 (AE-50177)

Technical information

Material	Stainless Steel	Optic value	28°, 32°, 51°	Cable	One cable gland supplied with 2 m of 2x1.0 sqmm outdoor cable
Light source	3 LED	CCT / CRI	2700K CRI80, 3000K CRI80, 4000K CRI80	Through wiring	Single cable entry
Power	8 W	Bug	B0-U4-G0	Lens / Reflector / Optic	Clear toughened glass
Lumen	506 - 779 lm	ULR	100%	MacAdam Ellipse	3 SDCM
Efficacy	63 - 97 lm/W	ULOR	100%	Lifetime L90B10 (hours)	> 120,000
Driver option	Remote driver (included)	Dimming type	On/Off, 1-10V, DALI	Lifetime L80B10 (hours)	> 120,000
Driver	Constant current (CC)	Product colours	Stainless Steel	Lifetime L80B50 (hours)	> 120,000
Input voltage	700 mA, 9 VDC	Weight	1.1 kg		
Optic	N, M, W	Operating temperature	-20 °C to 50 °C		

AE-50177

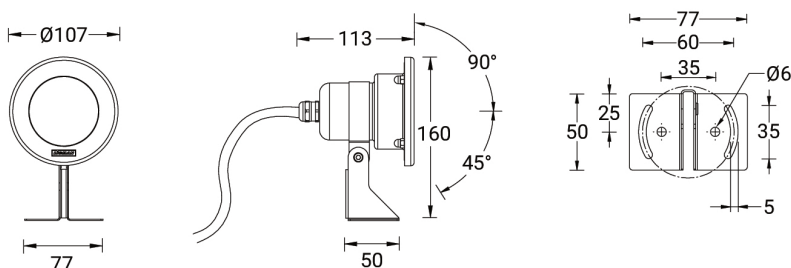

Accessories



DALI Control System
Control-DALI



Remote box IP65
A80191