

FORREY 16 (FOR-20062)



Product description

Top Ø320 mm - With louver



Luminaire Structure

- Die-cast aluminium housing
- Pre-treated before powder coating ensuring high corrosion resistance
- Extruded aluminium column
- Models with shade will have colour white coating at inside of shade luminaire and outside surface coating according to colour of luminaire

- Single cable entry
- One IP68 connector supplied with 0.2 m of 3x1.0 sqmm outdoor cable
- Stainless steel fasteners in grade 304 with zinc flake coating (ZFC)
- Durable silicone rubber gasket

- High-efficiency PMMA lens
- Integral control gear
- FORREY luminaires with opal lens and colder than 3000K CCT do not meet the IDA certification requirements

Optic

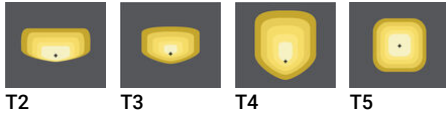

T2 T3 T4 T5

Product colour

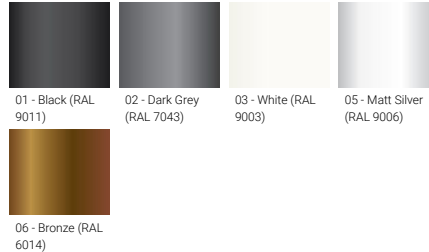

01 - Black (RAL 9011) 02 - Dark Grey (RAL 7043) 03 - White (RAL 9003) 05 - Matt Silver (RAL 9006) 06 - Bronze (RAL 6014)

Special finishes upon request

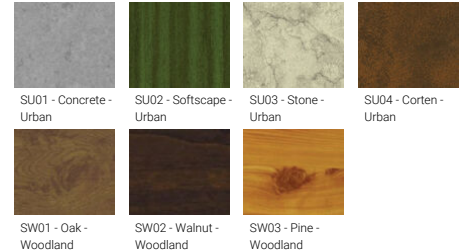

SU01 - Concrete - Urban SU02 - Softscape - Urban SU03 - Stone - Urban SU04 - Corten - Urban SW01 - Oak - Woodland SW02 - Walnut - Woodland SW03 - Pine - Woodland

FORREY 16 (FOR-20062)

Technical information

Material	Aluminium	Optic value	145°x84°, 126°x106°, 133°x116°, 163°	Operating temperature	-20 °C to 50 °C
Light source	1 COB	CCT / CRI	3000K CRI80, 4000K CRI80	Cable	One IP68 connector supplied with 0.2 m of 3x1.0 sqmm outdoor cable
Power	69.6 W	Bug	B3-U2-G1, B3-U3-G3	Through wiring	Single cable entry
Lumen	5976 - 6603 lm	ULR	1%	Lens / Reflector / Optic	High-efficiency PMMA lens
Efficacy	86 - 95 lm/W	ULOR	1%	MacAdam Ellipse	3 SDCM
Driver option	Integral control gear	CIE flux code n°3	93, 95, 96	Lifetime L90B10 (hours)	> 50,700
Driver	Constant current (CC)	Dimming type	On/Off, 1-10V, DALI	Lifetime L80B10 (hours)	> 63,500
Input voltage	220-240 V 50/60 Hz	Product colours	Black, Dark Grey, White, Matt Silver, Bronze, Concrete - Urban, Softscape - Urban, Stone - Urban, Corten - Urban, Oak - Woodland, Walnut - Woodland, Pine - Woodland	Lifetime L80B50 (hours)	> 63,500
Optic	T2, T3, T4, T5		Weight	15.0 kg	Variants (On/Off, 1-10V, DALI)

FOR-20062

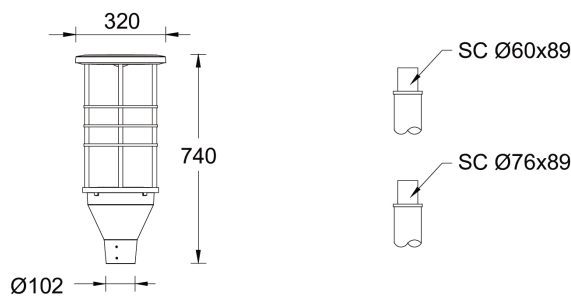

Accessories



DALI Control System
Control-DALI