

## FORREY 20 (FOR-30042)



### Product description

Ø880 - 933 mm - With shade & louver



### Luminaire Structure

- Die-cast aluminium housing and frame
- Pre-treated before powder coating ensuring high corrosion resistance
- Models with shade will have colour white coating at inside of shade luminaire and outside surface coating according to colour of luminaire
- Two cable entries for through wiring

- Stainless steel fasteners in grade 304 with zinc flake coating (ZFC)
- Durable silicone rubber gasket
- White coated aluminium reflector on the top of luminaire
- High-efficiency PMMA lens

- Integral control gear
- FORREY luminaires with opal lens and colder than 3000K CCT do not meet the IDA certification requirements

### Optic

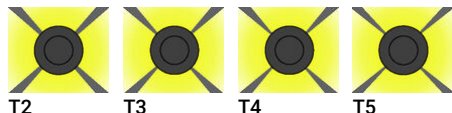

T2

T3

T4

T5

### Product colour



01 - Black (RAL 9011)

02 - Dark Grey (RAL 7043)

03 - White (RAL 9003)

05 - Matt Silver (RAL 9006)

06 - Bronze (RAL 6014)

### Special finishes upon request

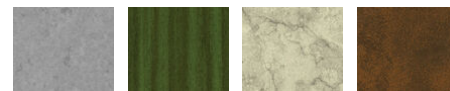

SU01 - Concrete - Urban

SU02 - Softscape - Urban

SU03 - Stone - Urban

SU04 - Corten - Urban



SW01 - Oak - Woodland

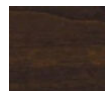

SW02 - Walnut - Woodland

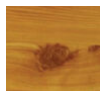

SW03 - Pine - Woodland

## FORREY 20 (FOR-30042)

### Technical information

<b>Material</b>	Aluminium	<b>Optic</b>	T2, T3, T4, T5	<b>Lens / Reflector / Optic</b>	White coated aluminium reflector on the top of luminaire, High-efficiency PMMA lens
<b>Light source</b>	1 COB	<b>Optic value</b>	145°x84°, 126°x106°, 133°x116°, 163°	<b>MacAdam Ellipse</b>	3 SDCM
<b>Power</b>	69.6 W	<b>CCT / CRI</b>	3000K CRI80, 4000K CRI80	<b>Lifetime L90B10 (hours)</b>	> 50,700
<b>Lumen</b>	5976 - 6603 lm	<b>Dimming type</b>	On/Off, 1-10V, DALI	<b>Lifetime L80B10 (hours)</b>	> 63,500
<b>Efficacy</b>	86 - 95 lm/W	<b>Product colours</b>	Black, Dark Grey, White, Matt Silver, Bronze, Concrete - Urban, Softscape - Urban, Stone - Urban, Corten - Urban, Oak - Woodland, Walnut - Woodland, Pine - Woodland	<b>Lifetime L80B50 (hours)</b>	> 63,500
<b>Driver option</b>	Integral control gear	<b>Weight</b>	16.6 kg	<b>Variants (On/Off, 1-10V, DALI)</b>	Compatible with EN/ IEC 60598-2-22: Suitable for emergency installations as central supply, non-maintained (Z0)
<b>Driver</b>	Constant current (CC)	<b>Operating temperature</b>	-20 °C to 50 °C		
<b>Input voltage</b>	220-240 V 50/60 Hz	<b>Through wiring</b>	Two cable entries for through wiring		

FOR-30042

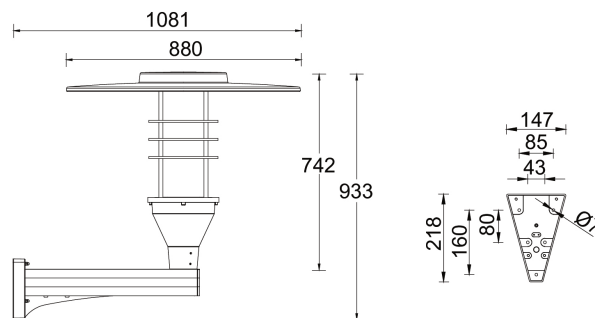

### Accessories

