

**GINI 2 (GN-30031)**



**Product description**

Down (Optic) & Up (Optic 2nd)



**Luminaire Structure**

- Die-cast aluminium housing
- Pre-treated before powder coating ensuring high corrosion resistance
- Two cable entries for through wiring
- Stainless steel fasteners in grade 304 with zinc flake coating (ZFC)
- Durable silicone rubber gasket
- Frosted toughened glass
- Integral control gear

**Optic**



G / G

**Product colour**

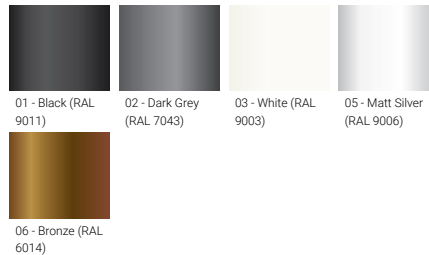

**Special finishes upon request**

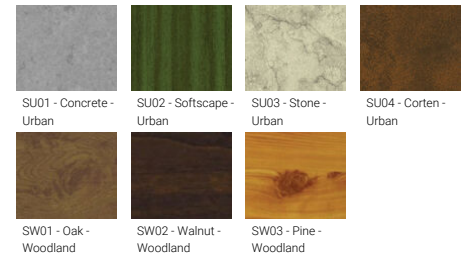

**GINI 2 (GN-30031)**

**Technical information**

|                      |                       |
|----------------------|-----------------------|
| <b>Material</b>      | Aluminium             |
| <b>Light source</b>  | 40 & 40 LED           |
| <b>Power</b>         | 25 W                  |
| <b>Lumen</b>         | 1866 - 1985 lm        |
| <b>Efficacy</b>      | 75 - 79 lm/W          |
| <b>Driver option</b> | Integral control gear |
| <b>Driver</b>        | Constant current (CC) |
| <b>Input voltage</b> | 220-240 V 50/60 Hz    |
| <b>Optic</b>         | G                     |
| <b>Optic value</b>   | 95°x 86°              |

|                          |  |
|--------------------------|--|
| <b>Optic (2nd)</b>       | G  |
| <b>Optic (2nd) value</b> | 95°x 86°   |
| <b>CCT / CRI</b>         | 3000K CRI80, 4000K CRI80   |
| <b>Bug</b>               | B1-U4-G0, B1-U5-G0   |
| <b>ULR</b>               | 51%  |
| <b>ULOR</b>              | 51%  |
| <b>CIE flux code n°3</b> | 98   |
| <b>Dimming type</b>      | On/Off, DALI   |
| <b>Product colours</b>   | Black, Dark Grey, White, Matt Silver, Bronze, Concrete - Urban, Softscape - Urban, Stone - Urban, Corten - Urban, Oak - Woodland, Walnut - Woodland, Pine - Woodland |
| <b>Weight</b>            | 3.0 kg   |

|                                 |   |
|---------------------------------|---|
| <b>Operating temperature</b>    | -20 °C to 40 °C   |
| <b>Through wiring</b>           | Two cable entries for through wiring  |
| <b>Lens / Reflector / Optic</b> | Frosted toughened glass   |
| <b>MacAdam Ellipse</b>          | 3 SDCM  |
| <b>Lifetime L90B10 (hours)</b>  | > 23,000  |
| <b>Lifetime L80B10 (hours)</b>  | > 45,000  |
| <b>Lifetime L80B50 (hours)</b>  | > 49,000  |
| <b>Variants (On/Off, DALI)</b>  | Compatible with EN/ IEC 60598-2-22: Suitable for emergency installations as central supply, non-maintained (Z0) |

**GN-30031**

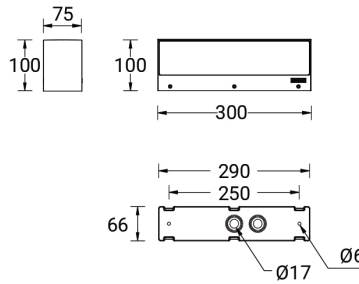

**Accessories**

