

LIGHTALK 7 (LA-30013)



Product description

Integral control gear - 610 mm - Class I - RGBW



Luminaire Structure

- Die-cast aluminium end-caps
- Extruded aluminium housing and sheet aluminium front frame
- Pre-treated before powder coating ensuring high corrosion resistance
- Two cable entries for through wiring
- Four IP67 connectors supplied with 2x0.2 m of 3x1.0 sqmm outdoor cable and 2x0.2 m of 2x0.5 sqmm outdoor shielded cable
- Stainless steel fasteners in grade 304 with zinc flake coating (ZFC)
- Durable silicone rubber gasket
- Clear toughened glass
- Integral control gear
- Remote box IP-rated is not included and is to be ordered separately for constant current (CC) products
- 24 VDC input, DMX/RDM address with stable signal

Optic

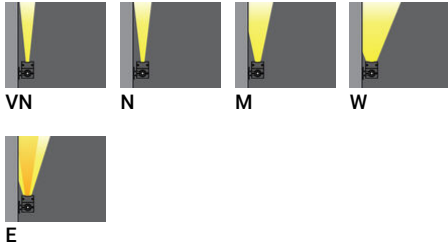

Product colour

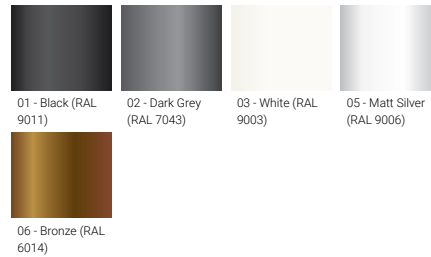

Special finishes upon request

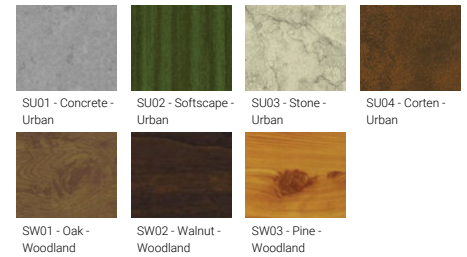

LIGHTALK 7 (LA-30013)

Technical information

Material	Aluminium	Optic	VN, N, M, W, E	Weight	3.8 kg
Light source	20 LED	Optic value	10°, 13°, 24°, 43°, 16° x 35°	Operating temperature	-20 °C to 40 °C
Power	33 W	CCT / CRI	RGBW30, RGBW40	Cable	Four IP67 connectors supplied with 2x0.2 m of 3x1.0 sqmm outdoor cable and 2x0.2 m of 2x0.5 sqmm outdoor shielded cable
Lumen	1677 - 2018 lm	Bug	B0-U5-G0	Through wiring	Two cable entries for through wiring
Efficacy	51 - 61 lm/W	ULR	100%	Lens / Reflector / Optic	Clear toughened glass
Driver option	Integral control gear	ULOR	100%	Variants (DMX/RDM)	Compatible with EN/ IEC 60598-2-22: Suitable for emergency installations as central supply, non-maintained (Z0)
Driver	Constant current (CC)	Dimming type	DMX, DMX/RDM		
Input voltage	220-240 V 50/60 Hz	Product colours	Black, Dark Grey, White, Matt Silver, Bronze, Concrete - Urban, Softscape - Urban, Stone - Urban, Corten - Urban, Oak - Woodland, Walnut - Woodland, Pine - Woodland		

LA-30013

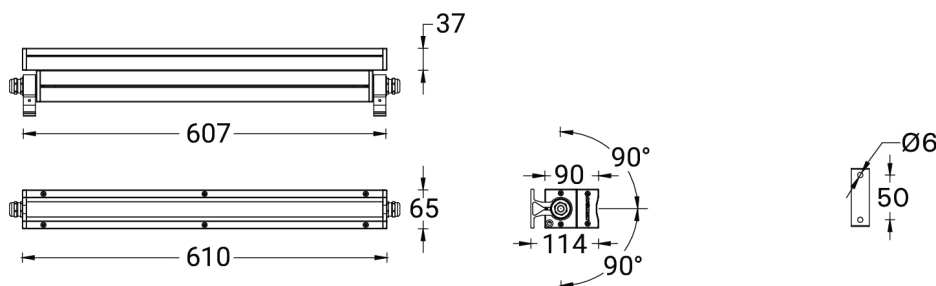

Accessories

