

LIGHTSOFT 2 (LH-10675-1MS)



Product description

186x186 mm - 600 mm - Square - IK08 - With integrated motion sensor - 1 side



Luminaire Structure

- Die-cast aluminium housing
- Extruded aluminium column
- Pre-treated before powder coating ensuring high corrosion resistance
- Single cable entry

- One IP68 connector supplied with 0.2 m of 3x1.0 sqmm outdoor cable
- Stainless steel fasteners in grade 304 with zinc flake coating (ZFC)
- Durable silicone rubber gasket
- Clear UV-stabilised polycarbonate diffuser

- Anodised, high-purity aluminium reflector
- Integral control gear

Optic



G

Product colour

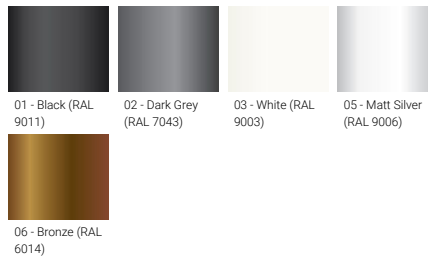

Special finishes upon request

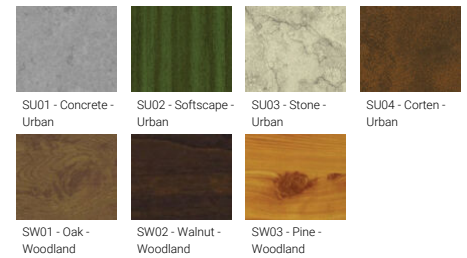

LIGHTSOFT 2 (LH-10675-1MS)

Technical information

Material	Aluminium	Optic value	360°	Operating temperature	-20 °C to 40 °C
Light source	12 LED	CCT / CRI	3000K CRI80, 4000K CRI80	Cable	One IP68 connector supplied with 0.2 m of 3x1.0 sqmm outdoor cable
Power	27 W	Bug	B1-U3-G1	Through wiring	Single cable entry
Lumen	1020 - 1050 lm	ULR	10%	Lens / Reflector / Optic	Clear UV-stabilised polycarbonate diffuser, Anodised, high-purity aluminium reflector
Efficacy	38 - 39 lm/W	ULOR	10%	MacAdam Ellipse	3 SDCM
Driver option	Integral control gear	CIE flux code n°3	72	Lifetime L90B10 (hours)	> 120,000
Driver	Constant current (CC)	Dimming type	1-10V	Lifetime L80B10 (hours)	> 120,000
Input voltage	220-240 V 50/60 Hz	Product colours	Black, Dark Grey, White, Matt Silver, Bronze, Concrete - Urban, Softscape - Urban, Stone - Urban, Corten - Urban, Oak - Woodland, Walnut - Woodland, Pine - Woodland	Lifetime L80B50 (hours)	> 120,000
Optic	G			Variants (1-10V)	Compatible with EN/ IEC 60598-2-22: Suitable for emergency installations as central supply, non-maintained (Z0)

LIGHTSOFT

Adjustable sensor (5 seconds - 30 minutes)
30° - 150° Sensitivity
Sensor detection area: 9 m

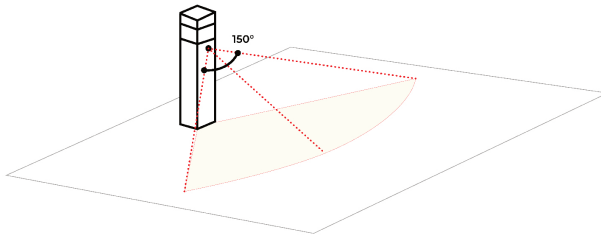

LH-10675-1MS

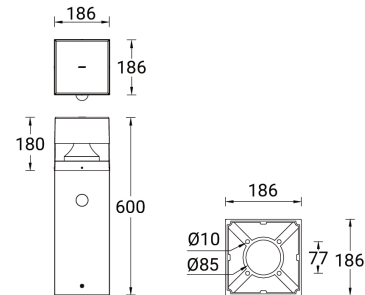

Accessories

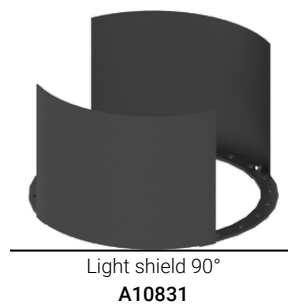
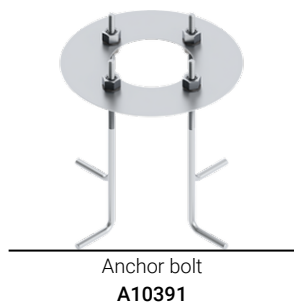

LIGHTSOFT 2 (LH-10675-1MS)

Remote controller for the motion
sensor - 1-10V (A14591)

A14291

Please contact the factory for technical details if you wish to use Anti-glare accessories, Colour filters, Lenses and slip glasses in combination.