

NYBRO 1 (NYB-80044)

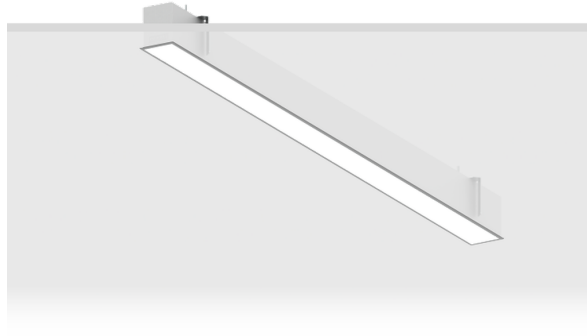

Product description

Down - 50x80 mm - 1764 mm



Luminaire Structure

- Die-cast aluminium end-caps and extruded aluminium profile with powder coating
- Stainless steel fasteners in grade 316
- Stainless steel brackets and screws for mounting
- PMMA diffuser with Opal (UGR <19) and micro prismatic (UGR <13) options for better glare control

- Up and down light distribution options
- Passive thermal management
- Integral control gear
- Wireless control available through Bluetooth connection

- Daylight and occupancy sensor options
- Emergency module (1 or 3 hours) is available upon request with 3 options (BASIC, SELF-TEST, PRO-DALI)

Optic



P

Product colour



01 - Black (RAL 9011) 03 - White (RAL 9003) 05 - Matt Silver (RAL 9006)

Special finishes upon request



SU01 - Concrete - Urban SU02 - Softscape - Urban SU03 - Stone - Urban SU04 - Corten - Urban



SW01 - Oak - Woodland SW02 - Walnut - Woodland SW03 - Pine - Woodland

NYBRO 1 (NYB-80044)

Technical information

Material	Aluminium	Input voltage	220-240 V 50/60 Hz	CIE flux code n°3	96, 98
Light source	216 LED	Optic	O, P	Dimming type	DALI
Power	38 W	Optic value	100°x86°, 93°x90°	Product colours	Black, White, Matt Silver, Concrete - Urban, Softscape - Urban, Stone - Urban, Corten - Urban, Oak - Woodland, Walnut - Woodland, Pine - Woodland
Lumen	3155 - 3385 lm	CCT / CRI	TW (2700K - 6500K)		
Efficacy	85 - 91 lm/W	Bug	B2-U1-G1	Weight	4.46 kg
Driver option	Integral control gear	ULR	0%	Operating temperature	-20 °C to 40 °C
Driver	Constant current (CC)	ULOR	0%	Variants (DALI)	Compatible with EN/ IEC 60598-2-22: Suitable for emergency installations as central supply, non-maintained (Z0)

NYB-80044

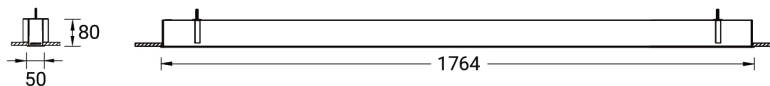

Accessories

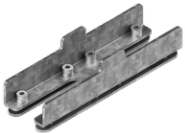

Continuous-coupler bracket
(40/50 mm Down profile)

A81881