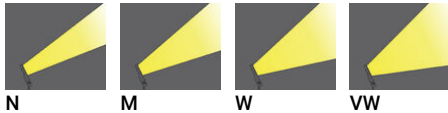

PITTSBURGH 1 (PIB-50006)**IP66****IK08****Product description**

Small - RGBW

**Luminaire Structure**

- Extruded aluminium housing
- Pre-treated before powder coating ensuring high corrosion resistance
- Galvanized steel arm mounted
- Thermal heat dissipation body
- Single cable entry, through wiring upon request
- Three IP68 connectors supplied with 0.2 m of 3x1.0 sqmm outdoor cable and 2x0.2 m of 2x0.5 sqmm outdoor shielded cable
- Stainless steel fasteners in grade 304 with zinc flake coating (ZFC)
- Durable silicone rubber gasket
- High-efficiency polycarbonate lens
- Clear toughened glass
- Integral control gear
- Surge protection 10kV

Optic

PITTSBURGH 1 (PIB-50006)

Technical information

Material	Aluminium	Driver	Constant current (CC)	Weight	5.5 kg
Light source	36 LED	Input voltage	220-240 V 50/60 Hz	Operating temperature	-20 °C to 35 °C
Power	80 W	Optic	N, M, W, VW, E	Cable	Three IP68 connectors supplied with 0.2 m of 3x1.0 sqmm outdoor cable and 2x0.2 m of 2x0.5 sqmm outdoor shielded cable
Lumen	3566 - 4564 lm	Optic value	9°, 16°, 33°, 64°, 43°x10°	Through wiring	Single cable entry, through wiring upon request
Efficacy	45 - 57 lm/W	CCT / CRI	RGBW30, RGBW40	Lens / Reflector / Optic	High-efficiency polycarbonate lens, Clear toughened glass
Driver option	Integral control gear	Dimming type	DMX/RDM		

PIB-50006

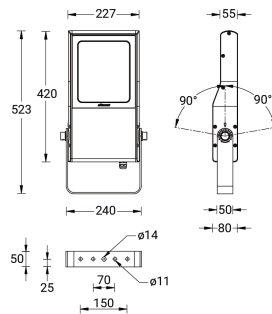

Accessories



Anti-glare visor
A54731



Anti-glare louvre
A54831



DMX/RDM Control System
Control-DMX-RDM

Please contact the factory for technical details if you wish to use Anti-glare accessories, Colour filters, Lenses and slip glasses in combination.