

**ROBUST 2 (RO-80486-S)****Product description**

With remote box IP-rated / remote driver - Round - Stainless frame

**Luminaire Structure**

- Die-cast aluminium housing
- Pre-treated before powder coating ensuring high corrosion resistance
- Single cable entry
- Stainless steel fasteners in grade 304 with zinc flake coating (ZFC)
- Durable silicone rubber gasket
- Clear toughened glass
- High-efficiency optical reflector
- Remote driver (included)

**Optic**

T2

T3

T4

**Product colour**

00 - Stainless Steel

**ROBUST 2 (RO-80486-S)**

**Technical information**

<b>Material</b>	Stainless Steel	<b>Optic value</b>	140°x 46°, 140°x 68°, 91°x 76°	<b>Operating temperature</b>	-20 °C to 40 °C
<b>Light source</b>	16 LED	<b>CCT / CRI</b>	3000K CRI80, 4000K CRI80	<b>Through wiring</b>	Single cable entry
<b>Power</b>	36 W	<b>Bug</b>	B1-U0-G1	<b>Lens / Reflector / Optic</b>	Clear toughened glass, High-efficiency optical reflector
<b>Lumen</b>	3476 - 3910 lm	<b>ULR</b>	0%	<b>MacAdam Ellipse</b>	3 SDCM
<b>Efficacy</b>	97 - 109 lm/W	<b>ULOR</b>	0%	<b>Lifetime L90B10 (hours)</b>	> 90,000
<b>Driver option</b>	Remote driver (included)	<b>CIE flux code n°3</b>	98	<b>Lifetime L80B10 (hours)</b>	> 90,000
<b>Driver</b>	Constant current (CC)	<b>Dimming type</b>	On/Off, 1-10V, DALI	<b>Lifetime L80B50 (hours)</b>	> 90,000
<b>Input voltage</b>	700 mA, 48 VDC	<b>Product colours</b>	Stainless Steel	<b>Variants (1-10V)</b>	Compatible with EN/ IEC 60598-2-22: Suitable for emergency installations as central supply, non-maintained (Z0)
<b>Optic</b>	T2, T3, T4	<b>Weight</b>	4.2 kg		

**RO-80486-S**

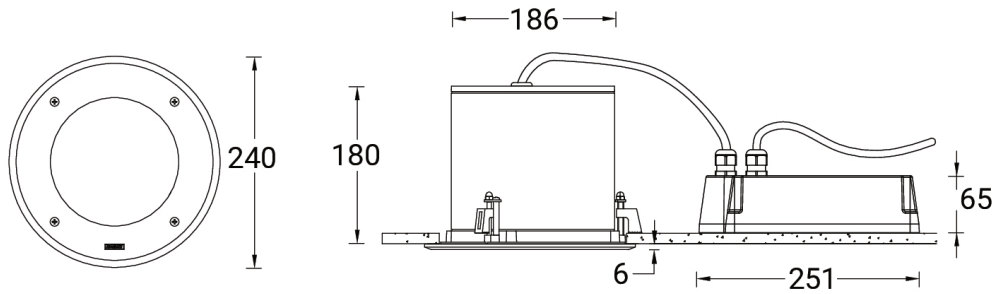

**Accessories**

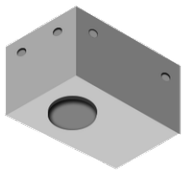

Concrete box modification upon request  
**CONCRETE-BOX**



DALI Control System  
**Control-DALI**