

STEAMER 1 (SE-90002-SO-60) (Version 1)**Product description**

Made to order for 60 W Vertical solar PV pole

**Luminaire Structure**

- Clear toughened glass

- High-efficiency PMMA lens

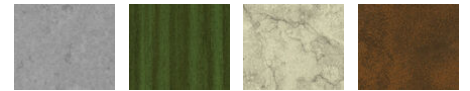
Optic**M** **W** **EW** **T2****T3** **T4** **ME****Product colour****01 - Black** (RAL 9011) **02 - Dark Grey** (RAL 7043) **03 - White** (RAL 9003) **05 - Matt Silver** (RAL 9006)**06 - Bronze** (RAL 6014)**Special finishes upon request****SU01 - Concrete - Urban** **SU02 - Softscape - Urban** **SU03 - Stone - Urban** **SU04 - Corten - Urban****SW01 - Oak - Woodland** **SW02 - Walnut - Woodland** **SW03 - Pine - Woodland**

STEAMER 1 (SE-90002-SO-60) (Version 1)

Technical information

Material	Aluminium
Light source	2 x 12 LED
Power	60 W
Lumen	7021 - 8116 lm
Efficacy	117 - 135 lm/W
Driver	Constant current (CC)
Input voltage	Solar 36 VDC

Optic	M, W, EW, T2, T3, T4, ME
Optic value	30°, 57°, 105°x115°, 136°x51°, 119°x86°, 102°x74°, 137°x58°
CCT / CRI	3000K CRI80, 4000K CRI80
Bug	B1-U0-G1, B2-U0-G0, B2-U0-G1, B2-U0-G2, B3-U0-G0, B3-U0-G1
ULR	0%
ULOR	0%
CIE flux code n°3	97, 98, 99

Dimming type	Dusk to Dawn, 2 Step dimming with motion sensor override, Solar Custom
Product colours	Black, Dark Grey, White, Matt Silver, Bronze, Concrete - Urban, Softscape - Urban, Stone - Urban, Corten - Urban, Oak - Woodland, Walnut - Woodland, Pine - Woodland
Weight	10.1 kg
Operating temperature	-20 °C to 40 °C
Lens / Reflector / Optic	Clear toughened glass, High-efficiency PMMA lens

**STEAMER 1
SE-90002**

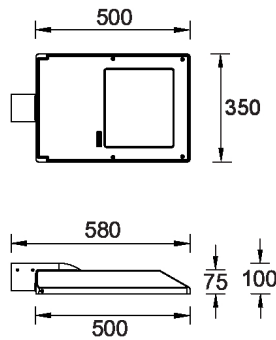

Accessories



Remote solar charge controller for Solar Integrated Bollards and Vertical Solar PV poles
A92691



Vertical solar PV pole 3
SOL-20021



Vertical solar PV pole 4
SOL-20031



Vertical solar PV pole 5
SOL-20041

STEAMER 1 (SE-90002-SO-60) (Version 1)



Vertical solar PV pole 7
SOL-20061



GPRS Module
A95591