

STEAMER 1 (SE-90002-SO-80) (Version 1)**Product description**

Made to order for 80 W Vertical solar PV pole

**Luminaire Structure**

- Clear toughened glass

- High-efficiency PMMA lens

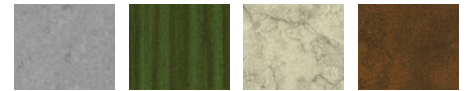
Optic**M W EW T2****T3 T4 ME****Product colour****01 - Black (RAL 9011) 02 - Dark Grey (RAL 7043) 03 - White (RAL 9003) 05 - Matt Silver (RAL 9006)****06 - Bronze (RAL 6014)****Special finishes upon request****SU01 - Concrete - Urban SU02 - Softscape - Urban SU03 - Stone - Urban SU04 - Corten - Urban****SW01 - Oak - Woodland SW02 - Walnut - Woodland SW03 - Pine - Woodland**

STEAMER 1 (SE-90002-SO-80) (Version 1)

Technical information

Material	Aluminium	Optic	M, W, EW, T2, T3, T4, ME	Dimming type	Dusk to Dawn, 2 Step dimming with motion sensor override, Solar Custom
Light source	4 x 12 LED	Optic value	30°, 57°, 105°x115°, 136°x51°, 119°x86°, 102°x74°, 137°x58°	Product colours	Black, Dark Grey, White, Matt Silver, Bronze, Concrete - Urban, Softscape - Urban, Stone - Urban, Corten - Urban, Oak - Woodland, Walnut - Woodland, Pine - Woodland
Power	80 W	CCT / CRI	3000K CRI80, 4000K CRI80	Weight	10.1 kg
Lumen	9361 - 10821 lm	Bug	B2-U0-G2, B3-U0-G0, B4-U0-G1	Operating temperature	-20 °C to 40 °C
Efficacy	117 - 135 lm/W	ULR	0%	Lens / Reflector / Optic	Clear toughened glass, High-efficiency PMMA lens
Driver	Constant current (CC)	ULOR	0%		
Input voltage	Solar 36 VDC	CIE flux code n°3	97, 98, 99		

**STEAMER 1
SE-90002**

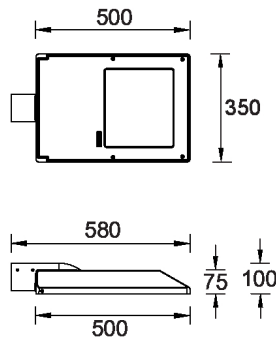

Accessories



Remote solar charge controller for Solar Integrated Bollards and Vertical Solar PV poles
A92691



Vertical solar PV pole 3
SOL-20021



Vertical solar PV pole 4
SOL-20031



Vertical solar PV pole 5
SOL-20041

STEAMER 1 (SE-90002-SO-80) (Version 1)



Vertical solar PV pole 7
SOL-20061



GPRS Module
A95591