

STEAMER 11 (SE-90022-SO-60)**Product description**

Made to order for 60 W Vertical solar PV pole

**Luminaire Structure**

- Clear toughened glass
- High-efficiency PMMA lens

- Integral control gear

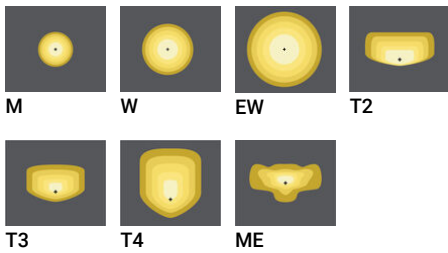
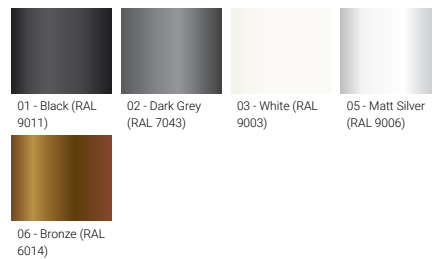
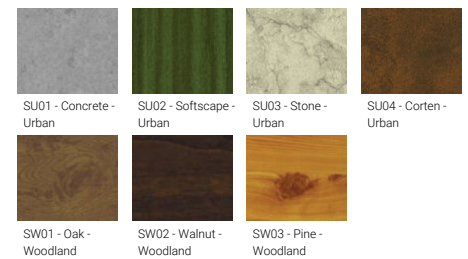
Optic**Product colour****Special finishes upon request**

STEAMER 11 (SE-90022-SO-60)

Technical information

Material	Aluminium
Light source	2 x 12 LED
Power	60 W
Lumen	7021 - 8116 lm
Efficacy	117 - 135 lm/W
Driver option	Integral control gear
Driver	Constant current (CC)

Input voltage	1100 mA, 72 VDC
Optic	M, W, EW, T2, T3, T4, ME
Optic value	30°, 57°, 105°x115°, 136°x51°, 119°x86°, 102°x74°, 137°x58°
CCT / CRI	3000K CRI80, 4000K CRI80
Dimming type	Dusk to Dawn, 2 Step dimming with motion sensor override, Solar Custom
Product colours	Black, Dark Grey, White, Matt Silver, Bronze, Concrete - Urban, Softscape - Urban, Stone - Urban, Corten - Urban, Oak - Woodland, Walnut - Woodland, Pine - Woodland
Weight	11.2 kg

Operating temperature	-20 °C to 40 °C
Lens / Reflector / Optic	Clear toughened glass, High-efficiency PMMA lens
MacAdam Ellipse	3 SDCM
Lifetime L90B10 (hours)	> 90,000
Lifetime L80B10 (hours)	> 90,000
Lifetime L80B50 (hours)	> 90,000

**STEAMER 11
SE-90022**

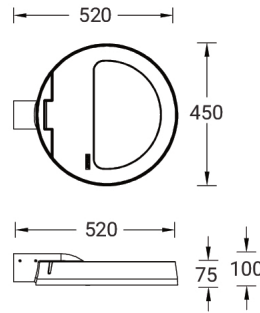

Accessories



Remote solar charge controller for Solar Integrated Bollards and Vertical Solar PV poles
A92691



Vertical solar PV pole 3
SOL-20021



Vertical solar PV pole 4
SOL-20031



Vertical solar PV pole 5
SOL-20041

STEAMER 11 (SE-90022-SO-60)



Vertical solar PV pole 7
SOL-20061



GPRS Module
A95591